

PB 2020-0238

Application for a Waiver of Subdivision



Town of Brunswick  
Building Department  
336 Town Office Road  
Troy, New York 12180

Date: MARCH 23, 2020  
MAY 27, 2020 NEWSURVEY ~~BOOK~~

Name	Address	Business Phone	Home or Cell Phone
Applicant	BILL GODELL		
Owner	ROBERT GODELL		
Buyer	"APPLICANT"		
Developer			
Attorney	BILL DOYLE	518 279-212	
Engineer			
Surveyor	FRED NETZGER	518 783-0688	

NOTE: ANY OF THE ABOVE MAY BE CONTACTED BY THE REVIEWING OFFICER

Address of Site: 121 DEEPKILL RD

Tax Map No.: 72.-9-41.2

Size of Original Parcel: 13.76 AC

Parcel size to be conveyed: 10 AC +/- (10.75)

Intended Use: RESIDENTIAL & OTHER ZONED USES

Description of parcel to be conveyed:

FIELD, HILL AREAS, WET AREAS

Original property description on Town Tax Rolls:

290 RURAL RESIDENTIAL

Describe parcels conveyed within the past 7 years (date, size and Purchaser):

NONE

- Scale Drawing attached. Shows Boundaries, adjacent property owners, public highways, public utilities, property lines including remainder of owner's tract, Min. scale 1" = 200'.
- Environmental Assessment Form filed
- \$250 Filing Fee paid

Signature of Owner, Applicant or Agent

William GODELL  
Printed or Typed Copy of Above

NOTE: IF OWNER IS NOT THE APPLICANT, THE APPLICANT SWEARS THAT THE PROPOSED WORK IS AUTHORIZED BY THE OWNER AND THAT THE APPLICANT IS AUTHORIZED TO MAKE SUCH APPLICATION.

Approved: \_\_\_\_\_





# Short Environmental Assessment Form

## Part 1 - Project Information

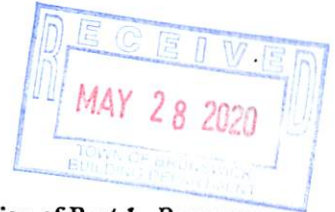

### Instructions for Completing

Part 1 - Project Information. The applicant or project sponsor is responsible for the completion of Part 1. Responses become part of the application for approval or funding, are subject to public review, and may be subject to further verification. Complete Part 1 based on information currently available. If additional research or investigation would be needed to fully respond to any item, please answer as thoroughly as possible based on current information.

Complete all items in Part 1. You may also provide any additional information which you believe will be needed by or useful to the lead agency; attach additional pages as necessary to supplement any item.

Part 1 - Project and Sponsor Information			
Name of Action or Project: <i>N/A</i>			
Project Location (describe, and attach a location map): <i>121 DEERKILL RD TROY NY 12180</i>			
Brief Description of Proposed Action: <i>SPLIT OFF PORTION OF 72-9-41.2</i>			
Name of Applicant or Sponsor: <i>BILL GODELL</i>		Telephone: <i>[REDACTED]</i>	E-Mail: <i>[REDACTED]</i>
Address: <i>25 BRICKNICK LA</i>			
City/PO: <i>SCHAGHTICOOK</i>		State: <i>NY</i>	Zip Code: <i>12154</i>
1. Does the proposed action only involve the legislative adoption of a plan, local law, ordinance, administrative rule, or regulation? If Yes, attach a narrative description of the intent of the proposed action and the environmental resources that may be affected in the municipality and proceed to Part 2. If no, continue to question 2.			NO YES <input checked="" type="checkbox"/> <input type="checkbox"/>
2. Does the proposed action require a permit, approval or funding from any other governmental Agency? If Yes, list agency(s) name and permit or approval: <i>IF HOUSE IS TO BE LOCATED TOWARDS BACK OF PARCEL, THEN DRIVEWAY WILL NEED TO CROSS A SMALL LOW FLOW CREEK. WILL NEED DEC PERMIT!</i>			NO YES <input checked="" type="checkbox"/> <input type="checkbox"/>
3.a. Total acreage of the site of the proposed action?		<i>9-10 AC</i> acres	
b. Total acreage to be physically disturbed?		<i>1-2</i> acres	
c. Total acreage (project site and any contiguous properties) owned or controlled by the applicant or project sponsor?		<i>9-10</i> acres	
4. Check all land uses that occur on, adjoining and near the proposed action.			
<input type="checkbox"/> Urban <input checked="" type="checkbox"/> Rural (non-agriculture) <input type="checkbox"/> Industrial <input type="checkbox"/> Commercial <input checked="" type="checkbox"/> Residential (suburban) <input type="checkbox"/> Forest <input checked="" type="checkbox"/> Agriculture <input type="checkbox"/> Aquatic <input type="checkbox"/> Other (specify): _____ <input type="checkbox"/> Parkland			



5. Is the proposed action, a. A permitted use under the zoning regulations?	NO <input type="checkbox"/>	YES <input checked="" type="checkbox"/>	N/A <input type="checkbox"/>
b. Consistent with the adopted comprehensive plan?	<input type="checkbox"/>	<input checked="" type="checkbox"/>	<input type="checkbox"/>
6. Is the proposed action consistent with the predominant character of the existing built or natural landscape?	NO <input type="checkbox"/>	YES <input checked="" type="checkbox"/>	
7. Is the site of the proposed action located in, or does it adjoin, a state listed Critical Environmental Area? If Yes, identify: _____	NO <input checked="" type="checkbox"/>	YES <input type="checkbox"/>	
8. a. Will the proposed action result in a substantial increase in traffic above present levels?	NO <input checked="" type="checkbox"/>	YES <input type="checkbox"/>	
b. Are public transportation service(s) available at or near the site of the proposed action?	<input checked="" type="checkbox"/>	<input type="checkbox"/>	
c. Are any pedestrian accommodations or bicycle routes available on or near site of the proposed action?	<input checked="" type="checkbox"/>	<input type="checkbox"/>	
9. Does the proposed action meet or exceed the state energy code requirements? If the proposed action will exceed requirements, describe design features and technologies: <u>NA</u>	NO <input type="checkbox"/>	YES <input type="checkbox"/>	
10. Will the proposed action connect to an existing public/private water supply? If No, describe method for providing potable water: <u>DRILLED WELL</u>	NO <input checked="" type="checkbox"/>	YES <input type="checkbox"/>	
11. Will the proposed action connect to existing wastewater utilities? If No, describe method for providing wastewater treatment: _____	NO <input checked="" type="checkbox"/>	YES <input type="checkbox"/>	
12. a. Does the site contain a structure that is listed on either the State or National Register of Historic Places?	NO <input checked="" type="checkbox"/>	YES <input type="checkbox"/>	
b. Is the proposed action located in an archeological sensitive area?	<input checked="" type="checkbox"/>	<input type="checkbox"/>	
13. a. Does any portion of the site of the proposed action, or lands adjoining the proposed action, contain wetlands or other waterbodies regulated by a federal, state or local agency?	NO <input type="checkbox"/>	YES <input checked="" type="checkbox"/>	
b. Would the proposed action physically alter, or encroach into, any existing wetland or waterbody? If Yes, identify the wetland or waterbody and extent of alterations in square feet or acres: <u>IF HOUSE IS TO BE LOCATED TOWARDS BACK OF PARCEL, THEN A 16 FOOT WIDE DRIVEWAY WILL NEED TO CROSS SMALL LOW FLOW CREEK (COULD BE FEET WIDE) ON FAR NORTH END OF WETLANDS 15' EACH SIDE OF CENTER - 30 X 16 = 480 SQ FT</u>	<input type="checkbox"/>	<input checked="" type="checkbox"/>	
14. Identify the typical habitat types that occur on, or are likely to be found on the project site. Check all that apply: <input type="checkbox"/> Shoreline <input type="checkbox"/> Forest <input checked="" type="checkbox"/> Agricultural/grasslands <input type="checkbox"/> Early mid-successional <input checked="" type="checkbox"/> Wetland <input type="checkbox"/> Urban <input type="checkbox"/> Suburban			
15. Does the site of the proposed action contain any species of animal, or associated habitats, listed by the State or Federal government as threatened or endangered?	NO <input checked="" type="checkbox"/>	YES <input type="checkbox"/>	
16. Is the project site located in the 100 year flood plain? <u>SEE APPENDIX A</u> <u>HOME SITE WOULD NOT BE IN WETLANDS ARE NOT</u>	NO <input checked="" type="checkbox"/>	YES <input type="checkbox"/>	
17. Will the proposed action create storm water discharge, either from point or non-point sources? If Yes, a. Will storm water discharges flow to adjacent properties? <input type="checkbox"/> NO <input type="checkbox"/> YES b. Will storm water discharges be directed to established conveyance systems (runoff and storm drains)? If Yes, briefly describe: <input type="checkbox"/> NO <input type="checkbox"/> YES	NO <input checked="" type="checkbox"/>	YES <input type="checkbox"/>	

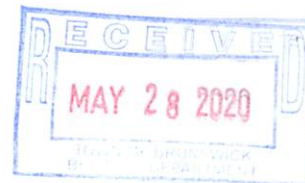

<p>18. Does the proposed action include construction or other activities that result in the impoundment of water or other liquids (e.g. retention pond, waste lagoon, dam)?          If Yes, explain purpose and size: _____          _____</p>	<p>NO <input checked="" type="checkbox"/></p>	<p>YES <input type="checkbox"/></p>
<p>19. Has the site of the proposed action or an adjoining property been the location of an active or closed solid waste management facility?          If Yes, describe: _____          _____</p>	<p>NO <input checked="" type="checkbox"/></p>	<p>YES <input type="checkbox"/></p>
<p>20. Has the site of the proposed action or an adjoining property been the subject of remediation (ongoing or completed) for hazardous waste?          If Yes, describe: _____          _____</p>	<p>NO <input checked="" type="checkbox"/></p>	<p>YES <input type="checkbox"/></p>
<p><b>I AFFIRM THAT THE INFORMATION PROVIDED ABOVE IS TRUE AND ACCURATE TO THE BEST OF MY KNOWLEDGE</b></p>		
<p>Applicant/sponsor name: [REDACTED]</p>	<p><u>William</u></p>	<p>Date: <u>MARCH 23, 2020</u></p>
<p>Signature: _____</p>	<p><u>WILLIAMS</u></p>	



Project: \_\_\_\_\_

Date: \_\_\_\_\_

### Short Environmental Assessment Form Part 2 - Impact Assessment

**Part 2 is to be completed by the Lead Agency.**

Answer all of the following questions in Part 2 using the information contained in Part 1 and other materials submitted by the project sponsor or otherwise available to the reviewer. When answering the questions the reviewer should be guided by the concept "Have my responses been reasonable considering the scale and context of the proposed action?"

	No, or small impact may occur	Moderate to large impact may occur
1. Will the proposed action create a material conflict with an adopted land use plan or zoning regulations?	<input checked="" type="checkbox"/>	<input type="checkbox"/>
2. Will the proposed action result in a change in the use or intensity of use of land?	<input checked="" type="checkbox"/>	<input type="checkbox"/>
3. Will the proposed action impair the character or quality of the existing community?	<input checked="" type="checkbox"/>	<input type="checkbox"/>
4. Will the proposed action have an impact on the environmental characteristics that caused the establishment of a Critical Environmental Area (CEA)?	<input checked="" type="checkbox"/>	<input type="checkbox"/>
5. Will the proposed action result in an adverse change in the existing level of traffic or affect existing infrastructure for mass transit, biking or walkway?	<input checked="" type="checkbox"/>	<input type="checkbox"/>
6. Will the proposed action cause an increase in the use of energy and it fails to incorporate reasonably available energy conservation or renewable energy opportunities?	<input checked="" type="checkbox"/>	<input type="checkbox"/>
7. Will the proposed action impact existing:		
a. public / private water supplies?	<input checked="" type="checkbox"/>	<input type="checkbox"/>
b. public / private wastewater treatment utilities?	<input checked="" type="checkbox"/>	<input type="checkbox"/>
8. Will the proposed action impair the character or quality of important historic, archaeological, architectural or aesthetic resources?	<input checked="" type="checkbox"/>	<input type="checkbox"/>
9. Will the proposed action result in an adverse change to natural resources (e.g., wetlands, waterbodies, groundwater, air quality, flora and fauna)?	<input checked="" type="checkbox"/>	<input type="checkbox"/>
10. Will the proposed action result in an increase in the potential for erosion, flooding or drainage problems?	<input checked="" type="checkbox"/>	<input type="checkbox"/>
11. Will the proposed action create a hazard to environmental resources or human health?	<input checked="" type="checkbox"/>	<input type="checkbox"/>

6875

Agency Use Only [If applicable]

Project: \_\_\_\_\_

Date: \_\_\_\_\_

### Short Environmental Assessment Form Part 3 Determination of Significance

For every question in Part 2 that was answered "moderate to large impact may occur", or if there is a need to explain why a particular element of the proposed action may or will not result in a significant adverse environmental impact, please complete Part 3. Part 3 should, in sufficient detail, identify the impact, including any measures or design elements that have been included by the project sponsor to avoid or reduce impacts. Part 3 should also explain how the lead agency determined that the impact may or will not be significant. Each potential impact should be assessed considering its setting, probability of occurring, duration, irreversibility, geographic scope and magnitude. Also consider the potential for short-term, long-term and cumulative impacts.

NA

<input type="checkbox"/>	Check this box if you have determined, based on the information and analysis above, and any supporting documentation, that the proposed action may result in one or more potentially large or significant adverse impacts and an environmental impact statement is required.
<input type="checkbox"/>	Check this box if you have determined, based on the information and analysis above, and any supporting documentation, that the proposed action will not result in any significant adverse environmental impacts.
_____	_____
Name of Lead Agency	Date
_____	_____
Print or Type Name of Responsible Officer in Lead Agency	Title of Responsible Officer
_____	_____
Signature of Responsible Officer in Lead Agency	Signature of Preparer (if different from Responsible Officer)

**PRINT FORM**

10/8

# TAX MAP

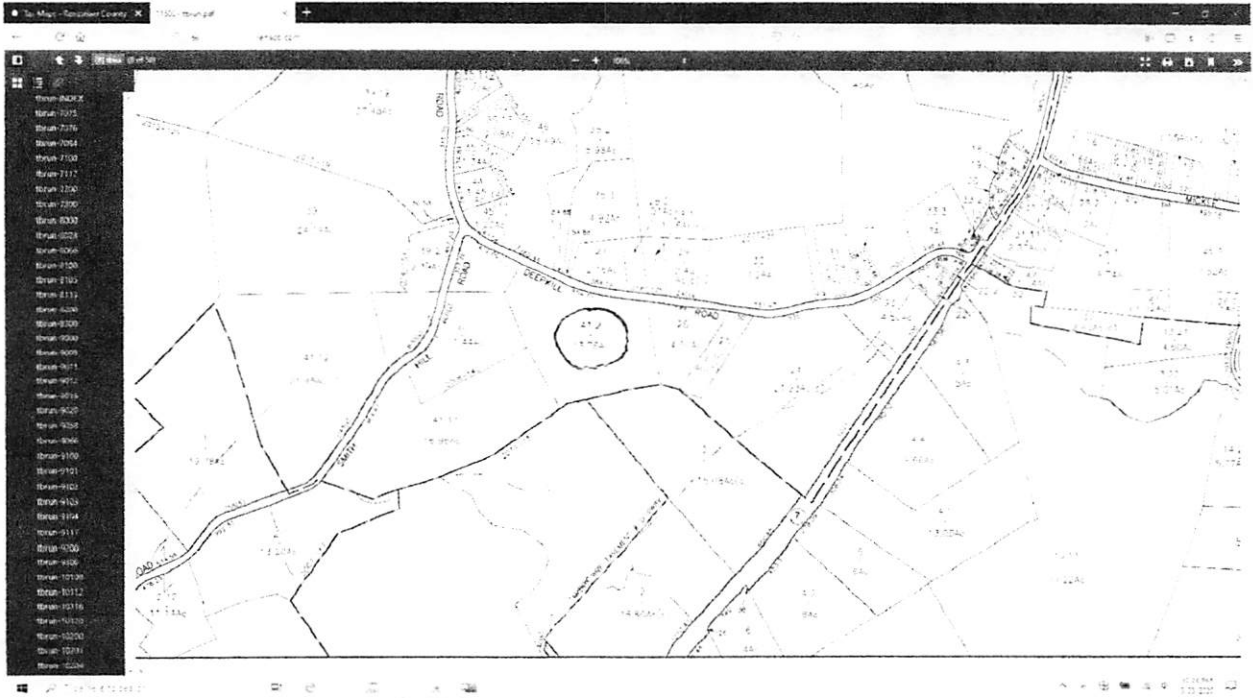

TAXID is 121 DEEPKILL RD TROY NY 12180

392200

72.-9-41.2



# 121 Deepkill Rd in Troy

April 22, 2020 at 4:52 AM

From "Buetow, William S (DEC)"

Hello Bill,  
Sorry I did not get back to you sooner. I did look for the 100-year floodplain on your property and there is no FEMA 100-year floodplain or flood way mapped on the property

**William Buetow**  
Biologist 1 (Ecology),  
New York State Department of Environmental Conservation  
1130 North Westcott Rd. Schenectady, NY 12306  
P: (518) 357-2049 | [william.buetow@dec.ny.gov](mailto:william.buetow@dec.ny.gov)

A

SWB

TOWN VILLAGE CITY OF BRUNSWICK  
(circle one)

Application # \_\_\_\_\_

# Agricultural Data Statement

Date 5/28/21

**Instructions:** This form must be completed for any application for a special use permit, site plan approval, use variance or a subdivision approval requiring municipal review that would occur on property within 500 feet of a farm operation located in a NYS Dept. of Ag & Markets certified Agricultural District.

Applicant	Owner if Different from Applicant
Name: <u>BILL GODELL</u> Address: <u>25 BRUNSWICK RD SPRINGVILLE NY 12154</u>	Name: <u>ROBERT GODELL</u> Address: <u>121 DEERKILL RD TRUY NY 12150</u>

1. Type of Application:  Special Use Permit;  Site Plan Approval;  Use Variance;  
(circle one or more)  Subdivision Approval WAIVER OF SUBDIVISION
2. Description of proposed project: SPLIT 10 AC FARM PARCEL 72.-9-41.2  
FOR SINGLE FAMILY HOME.

3. Location of project: Address: 121 DEERKILL  
Tax Map Number (TMP) 72.-9-41.2

4. Is this parcel within an Agricultural District?  NO  YES (Check with your local assessor if you do not know)
5. If YES, Agricultural District Number A40
6. Is this parcel actively farmed?  NO  YES
7. List all farm operations within 500 feet of your parcel. Attach additional sheets if necessary.

Name: <u>DAVE JARBOY</u> Address: <u>RT 7 BRUNSWICK</u> Is this parcel actively farmed? <input type="checkbox"/> NO <input checked="" type="checkbox"/> YES	Name: _____ Address: _____ Is this parcel actively farmed? <input type="checkbox"/> NO <input type="checkbox"/> YES
Name: _____ Address: _____ Is this parcel actively farmed? <input type="checkbox"/> NO <input type="checkbox"/> YES	Name: _____ Address: _____ Is this parcel actively farmed? <input type="checkbox"/> NO <input type="checkbox"/> YES

[Redacted Signature]  
Signature of Applicant

[Redacted Signature]  
Signature of Owner (if other than applicant)

Reviewed by: \_\_\_\_\_  
Signature of Municipal Official Date

NOTE TO REFERRAL AGENCY: County Planning Board review is required. A copy of the Agricultural Data Statement must be submitted along with the referral to the County Planning Department.

AGRICULTURAL DATA STATEMENT

FOR APPLICATION OF  
WAIVER OF SUBDIVISION

1. Name and address of applicant:

BILL GODELL  
25 BROCKNICK WA  
SCRAHNTICORE NY 12154



2. Location of the proposed action:

121 DEEPKILL RD, BRUNSWICK

3. Description of the proposed action to include: (1) Size of parcel or acreage to be acquired and tax map identification number of tax parcel(s) involved; (2) The type of action proposed (e.g., single-family dwelling) or subdivision, multi-family development, apartment complex, commercial or industrial facility, school, community or public service facility, airport, etc.) and (3) project density.

[Please provide this information on the reverse side of this application and attach additional description as necessary.] SURVEY ATTACHED

4. Name, address, telephone number and type of farm of owner(s) of land within the agricultural district which land contains farm operation(s) and upon which the project is proposed or which is located within 500 feet of the boundary of the property upon which the project is proposed:

A. Name: DAVE TARBOX  
Address & Telephone #: RT 7, BRUNSWICK 518 312-2914  
Type of farm: DAIRY, BEEF

B. Name: \_\_\_\_\_  
Address & Telephone #: \_\_\_\_\_  
Type of farm: \_\_\_\_\_

C. Name: \_\_\_\_\_  
Address & Telephone #: \_\_\_\_\_  
Type of farm: \_\_\_\_\_

D. Name: \_\_\_\_\_  
Address & Telephone #: \_\_\_\_\_  
Type of farm: \_\_\_\_\_

5. Tax map or other map showing the site of the proposed project relative to the location of farm operations identified in the ADS.

SURVEY MAP ATTACHED SHOWING BORDERS WITH FARM PROPERTY,